

D4BH

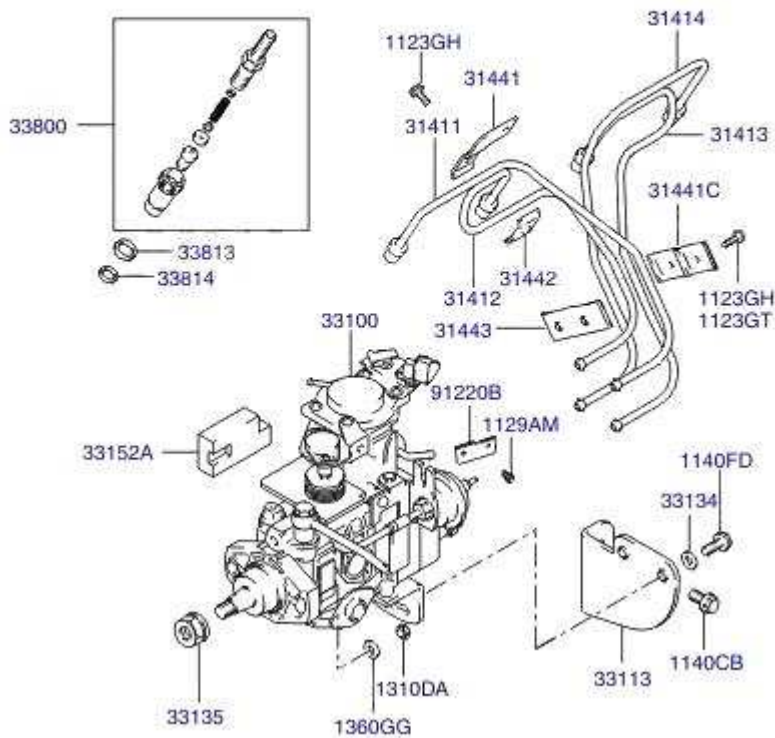

| Article | Part No. | Description |
|--------------------------|--------------|--|
| BOLT | 11233-06163 | D4BH(4D56 TCI); FUEL INJ-ELECTRONIC TYPE |
| BOLT | 11233-08163 | D4BH(4D56 TCI); FUEL INJ-ELECTRONIC TYPE |
| BOLT | 11290-08163 | D4BH(4D56 TCI); FUEL INJ-ELECTRONIC TYPE |
| BOLT | 11401-10163 | D4BH(4D56 TCI); FUEL INJ-ELECTRONIC TYPE |
| BOLT | 11403-08163 | D4BH(4D56 TCI); FUEL INJ-ELECTRONIC TYPE |
| NUT | 13100-08003 | D4BH(4D56 TCI); FUEL INJ-ELECTRONIC TYPE |
| WASHER-SPRING | 13602-08003 | D4BH(4D56 TCI); FUEL INJ-ELECTRONIC TYPE |
| PIPE-INJECTION NO.1 | 31411-42000 | D4BH(4D56 TCI); FUEL INJ-ELECTRONIC TYPE |
| PIPE-INJECTION NO.2 | 31412-42000 | D4BH(4D56 TCI); FUEL INJ-ELECTRONIC TYPE |
| PIPE-INJECTION NO.3 | 31413-42000 | D4BH(4D56 TCI); FUEL INJ-ELECTRONIC TYPE |
| PIPE-INJECTION NO.4 | 31414-42000 | D4BH(4D56 TCI); FUEL INJ-ELECTRONIC TYPE |
| CLAMP(A) | 31441-42000 | D4BH(4D56 TCI); FUEL INJ-ELECTRONIC TYPE |
| CLAMP"A"ASSY | 31441-42320 | D4BH(4D56 TCI); FUEL INJ-ELECTRONIC TYPE |
| CLAMP"B" | 31442-42000 | D4BH(4D56 TCI); FUEL INJ-ELECTRONIC TYPE |
| CLAMP"C" | 31443-42000 | D4BH(4D56 TCI); FUEL INJ-ELECTRONIC TYPE |
| PUMP ASSY-FUEL INJECTION | 33105-42700 | D4BH(4D56 TCI); FUEL INJ-ELECTRONIC TYPE |
| | 33105-42700B | D4BH(4D56 TCI); FUEL INJ-ELECTRONIC TYPE |
| | 33105-42700A | D4BH(4D56 TCI); FUEL INJ-ELECTRONIC TYPE |
| BRACKET-F/INJECTION PUMP | 33113-42000 | D4BH(4D56 TCI); FUEL INJ-ELECTRONIC TYPE |
| WASHER | 33134-42000 | D4BH(4D56 TCI); FUEL INJ-ELECTRONIC TYPE |
| NUT | 33131-42000 | D4BH(4D56 TCI); FUEL INJ-ELECTRONIC TYPE |

| | | |
|--------------------------------|--------------|--|
| INSULATOR-FUEL INJECTION PUMP | 33152-42100 | D4BH(4D56 TCI); FUEL INJ-ELECTRONIC TYPE |
| NOZZLE & HOLDER ASSY-INJECTION | 33800-42500 | D4BH(4D56 TCI); FUEL INJ-ELECTRONIC TYPE |
| | 33800-42510 | D4BH(4D56 TCI); FUEL INJ-ELECTRONIC TYPE |
| INJECTOR ASSY-FUEL | 33801-4X500 | 2900 CC; FUEL INJ-ELECTRONIC TYPE |
| | 33801-4X810 | 2900 CC; FUEL INJ-ELECTRONIC TYPE |
| | 33801-4X800 | 2900 CC; FUEL INJ-ELECTRONIC TYPE |
| GASKET-INJECTOR | 33813-4X500 | 2900 CC; FUEL INJ-ELECTRONIC TYPE |
| CLIP-INJECTOR CONN. | 33810-4X530 | 2900 CC; FUEL INJ-ELECTRONIC TYPE |
| GASKET-HOLDER | 33813-42000 | D4BH(4D56 TCI); FUEL INJ-ELECTRONIC TYPE |
| GASKET-NOZZLE | 33814-42001 | D4BH(4D56 TCI); FUEL INJ-ELECTRONIC TYPE |
| | 33814-42000 | D4BH(4D56 TCI); FUEL INJ-ELECTRONIC TYPE |
| BRKT-WIRING | 91255-H1110 | D4BH(4D56 TCI); FUEL INJ-ELECTRONIC TYPE |
| GASKET-NOZZLE | 0SL01-13651 | 2900 CC; FUEL INJ-ELECTRONIC TYPE |
| PIPE ASSY-HPP | 31500-4X520 | 2900 CC; FUEL INJ-ELECTRONIC TYPE |
| RAIL-COMMON | 31500-4X700 | 2900 CC; FUEL INJ-ELECTRONIC TYPE |
| | 31500-4X500 | 2900 CC; FUEL INJ-ELECTRONIC TYPE |
| BRKT-COMMON RAIL | 31500-4X511 | 2900 CC; FUEL INJ-ELECTRONIC TYPE |
| PIPE ASSY-FUEL INJ 1 | 31500-4X530 | 2900 CC; FUEL INJ-ELECTRONIC TYPE |
| PIPE ASSY-FUEL INJ2 3 4 | 31500-4X540 | 2900 CC; FUEL INJ-ELECTRONIC TYPE |
| CLIP-PIPE HPP | 31500-4X610 | 2900 CC; FUEL INJ-ELECTRONIC TYPE |
| PUMP-HIGH PRESSURE | 33100-4X500 | 2900 CC; FUEL INJ-ELECTRONIC TYPE |
| | 33100-4X700 | 2900 CC; FUEL INJ-ELECTRONIC TYPE |
| BRKT-HIGH PRESSURE PUMP | 33110-4X510 | 2900 CC; FUEL INJ-ELECTRONIC TYPE |
| INJECTOR | 33800-4X500 | 2900 CC; FUEL INJ-ELECTRONIC TYPE |
| | 33800-4X800 | 2900 CC; FUEL INJ-ELECTRONIC TYPE |
| BOLT-INJECTOR CLAMP | 33800-4X530 | 2900 CC; FUEL INJ-ELECTRONIC TYPE |
| CLAMP-INJECTOR | 33800-4X570 | 2900 CC; FUEL INJ-ELECTRONIC TYPE |
| W/H ASSY-INJECTOR | 33810-4X600 | 2900 CC; FUEL INJ-ELECTRONIC TYPE |
| BOLT | K9979-61035B | 2900 CC; FUEL INJ-ELECTRONIC TYPE |
| BOLT | K9979-61050B | 2900 CC; FUEL INJ-ELECTRONIC TYPE |
| BOLT | K9979-60845B | 2900 CC; FUEL INJ-ELECTRONIC TYPE |
| BOLT | K9979-60830B | 2900 CC; FUEL INJ-ELECTRONIC TYPE |
| BOLT | K9979-60820B | 2900 CC; FUEL INJ-ELECTRONIC TYPE |
| NUT-FLANGE | K9994-00500B | 2900 CC; FUEL INJ-ELECTRONIC TYPE |
| BOLT | K9979-60835B | 2900 CC; FUEL INJ-ELECTRONIC TYPE |